

PS-XXXX-140C Series

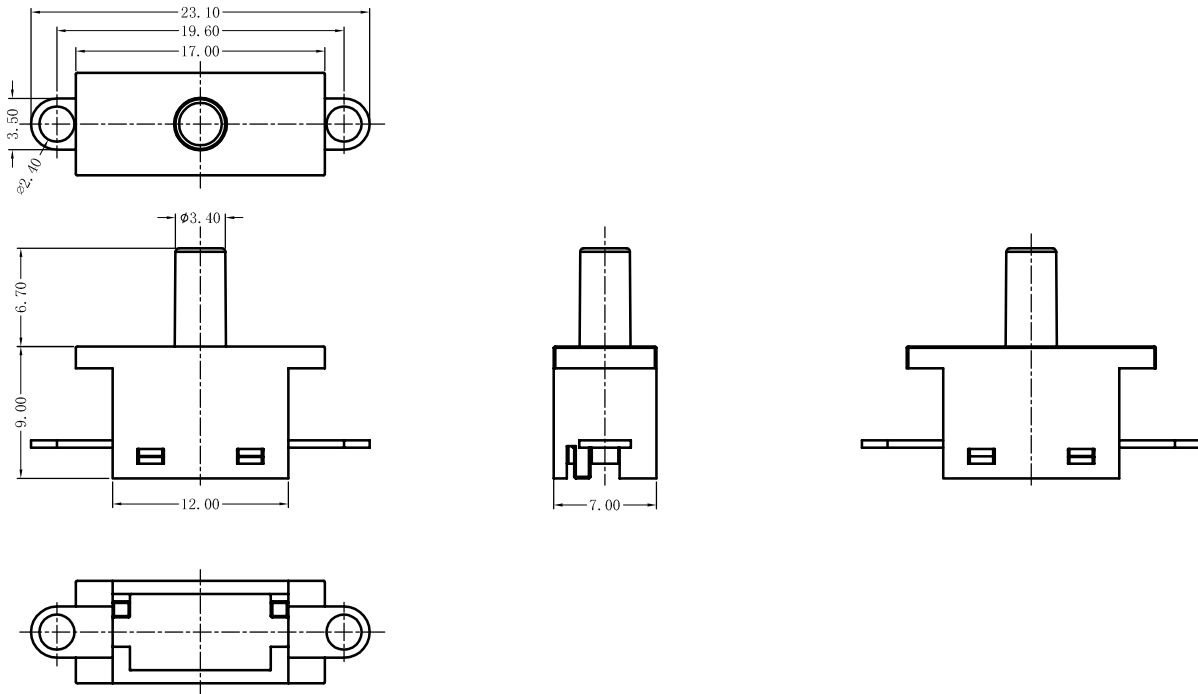

PS -

1	1	0	3
---	---	---	---

 - 140C - K1 - T1

Function	Current
11 (ON)-OFF	03
	3A 125V AC
	1.5A 250V AC

Knob Type	Terminal Type
<div style="display: flex; align-items: center;"> <div style="margin-right: 5px;">K1</div> </div>	<div style="display: flex; align-items: center;"> <div style="margin-right: 5px;">T1</div> </div>